

2. According to the installation plan, after drilling the hole position on the wall, the bracket 3 is fixed on the wall surface. Then the bracket 1, bracket 2, bracket 3 is assembled as shown. Make sure that the bracket is securely mounted (3 parts of the fastening bracket are supplied with screws.)

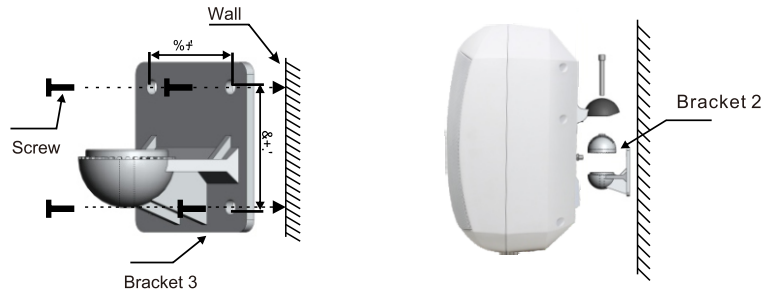

3. According to the installation plan in the adjustable range, adjust the most appropriate height, and then tighten the screws.

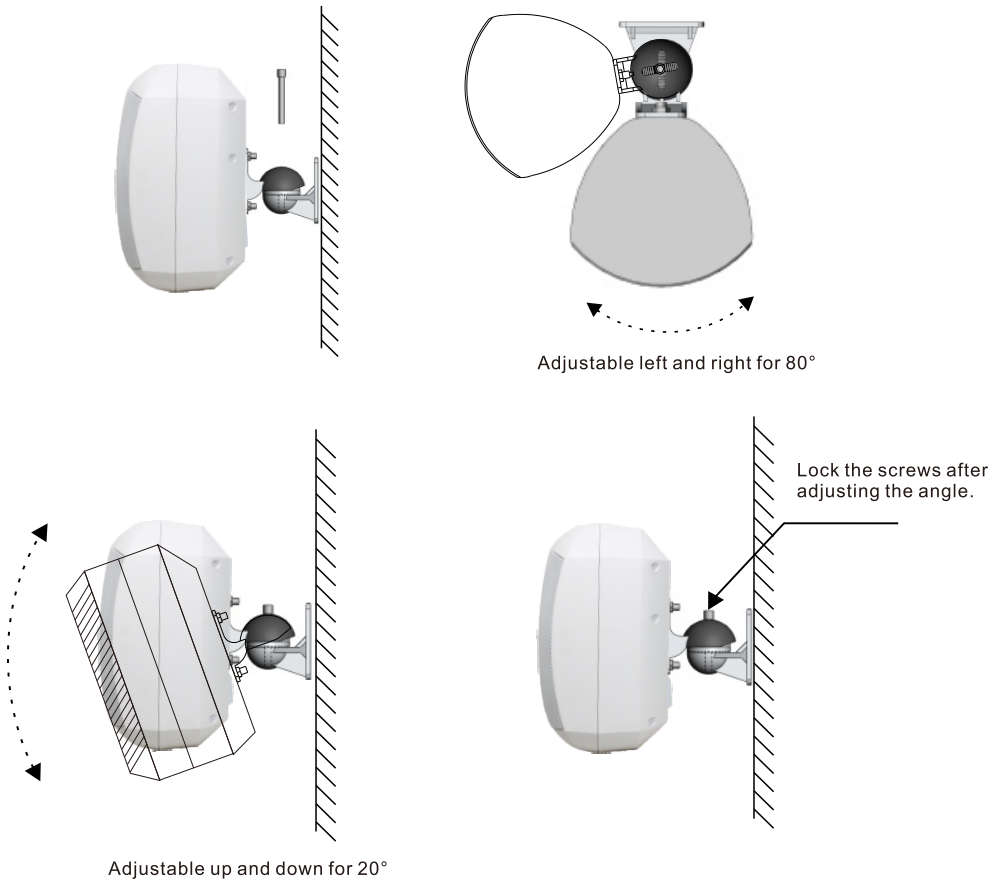

# User's Manual



## Indoor/Outdoor Wall Mount Speaker

**CLIMATE IPSub -Black**  
**CLIMATE IPSub -Pearl**



Specifications are subject to be changed without notice.



## Features

- ▶ All weather loudspeakers for music and speech (It must be installed facing downward for water resistance.)
- ▶ Elegant and stylish design with great sound
- ▶ Equipped with a powerful 8-inch subwoofer
- ▶ With built-in low pass filter
- ▶ PP Enclosure, and 360 degree aluminum mounting bracket
- ▶ 70V/100V speaker with power tapping or as a low-impedance 8ohm speaker
- ▶ Supplied with 360degree rotatable bracket for horizontal and vertical installation angle adjustment
- ▶ Black and white color optional

## Specification

Model	CLIMATE IPSub -Pearl	CLIMATE IPSub -Black
Power Taps	25W/50W/100W/OFF-8ohm	
Power at 8ohm	120W	
Peak Power	200W	
SPL@ 1M	85±3dB	
Max SPL@ 1M	105dB	
Freq. Response	65-500Hz	
Dispersion Angel	Vertical: 80° and Horizontal: 100° (75Hz)	
Product Size	395x260x230mm	
Installation	Wall mount	
Enclosure Material	PP Enclosure and 360-degree metal mounting bracket	
Net Weight	4.9kg	
Color	White	Black
Speaker	8" subwoofer x1	



## Installation

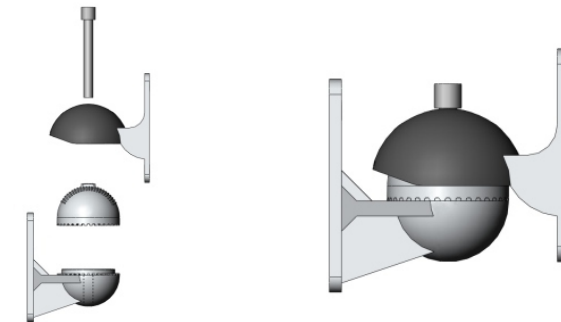
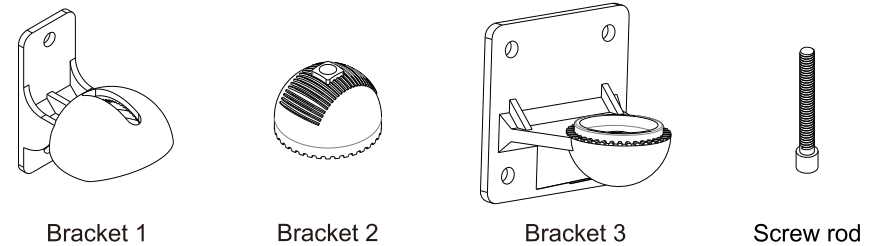

## Bracket Accessories

Split the mounting bracket into 1,2,3, three parts. Fit two six point screws into the mounting slot of the speaker's back (parallel to the wall speaker to help fit the screws

**!** When placing speakers horizontally, be careful not to touch and load the front of the speaker net with hard facing, otherwise it will deform the front net.

1. Fix the Bracket 1 as shown, tighten the screws according to the installation plan

